

# IF YOU...



MIX IT. FILL IT. PACK IT. SHIP IT.

## WE HAVE A **PRODUCT** FOR YOU

Part #30WO15

Plastic Oval & Oblong Bottles

15 oz. (450 ml) Clear PET Plastic Oval Bottle,  
28mm 28-410



The  
**CARY**COMPANY  
Est. 1895

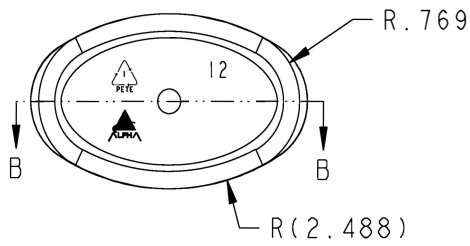
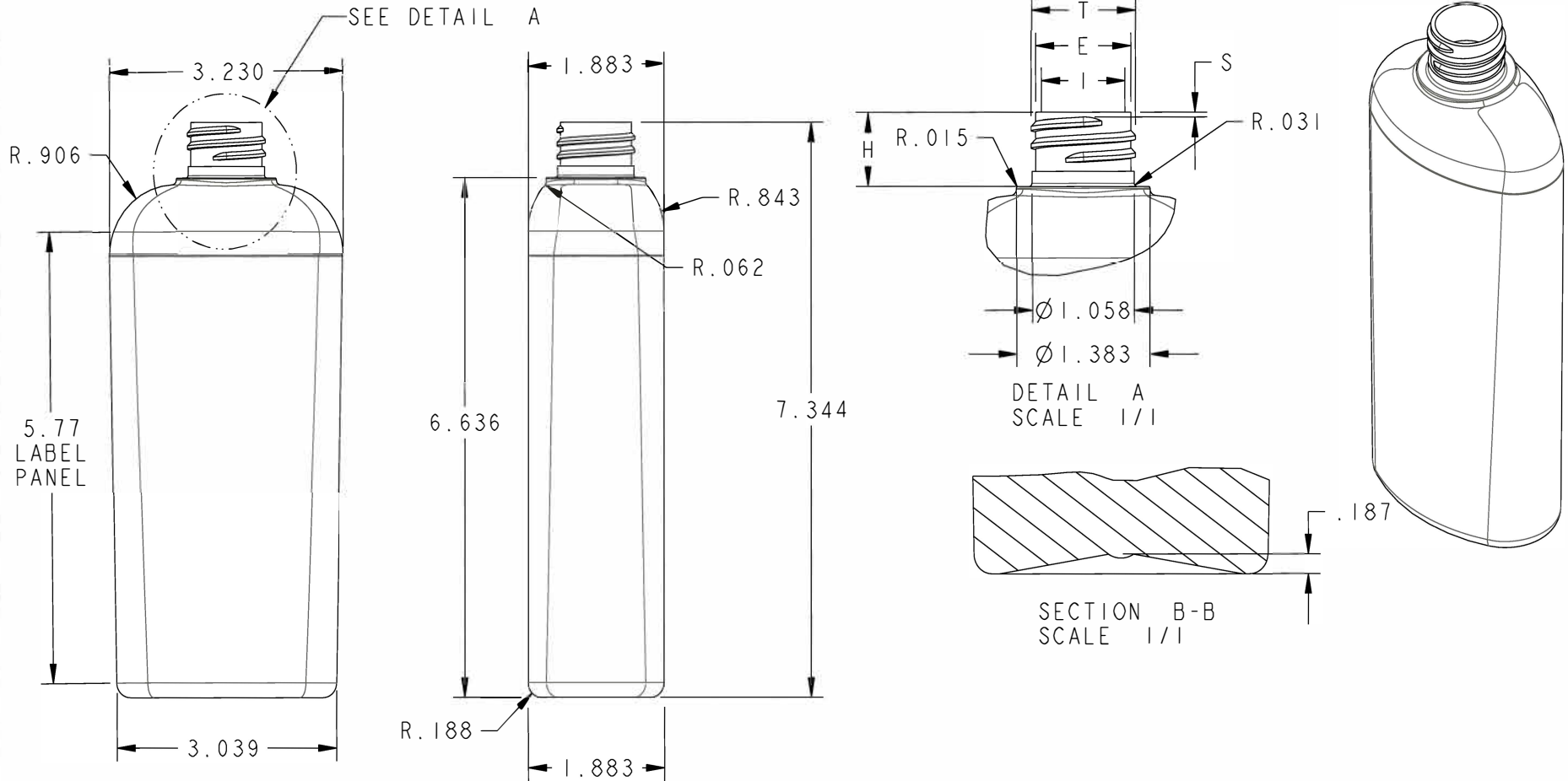

Neck Finish: M28SP410		<b>DISCLAIMER:</b> Cary assumes no responsibility for form, fit and function of closures, accessories, and/or shelf life and compatibility of intended contents with this bottle.							
<b>Min Thk</b>	.006	<b>Color</b>	All Colors	<b>Weight</b>	37.5 Gms±1	<b>Std. Pack</b>	16,8,Stack	<b>Revisions</b>	
All measurements are in inches, [Metric]								Scale:	Drawn By: SCT
Neck Dimensions:								Date:	04-27-06
T =	1.078±.010							Tolerance: Where not shown Decimal ±0.05 [1,27] Angular ±1°	
E =	.984±.010							<b>450ml OVAL, VALE, PET, 28-410 CT</b>	
H =	.708±.015							DwgRev	
I =	.864±.015							-	
S =	.046±.015							Material: PET	
				Overflow Capacity: 475 ml ± 11				Approved By: SJ	
								Drawing NO: P0450XVVL028B	