

IF YOU...

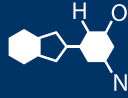

MIX IT. FILL IT. PACK IT. SHIP IT.

WE HAVE A PRODUCT FOR YOU

Part # 67W63F

Flapper Caps

63mm 63-485 White Dual Flapper Cap,
7 Holes, Pressure Sensitive Liner



The
CARYCOMPANY
Est. 1895

1195 W. Fullerton Ave. | Addison, IL 60101 | T: 630.629.6600 | F: 630.629.3690 | TheCaryCompany.com

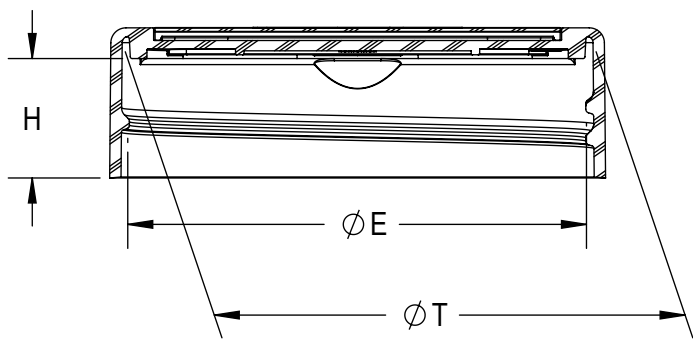
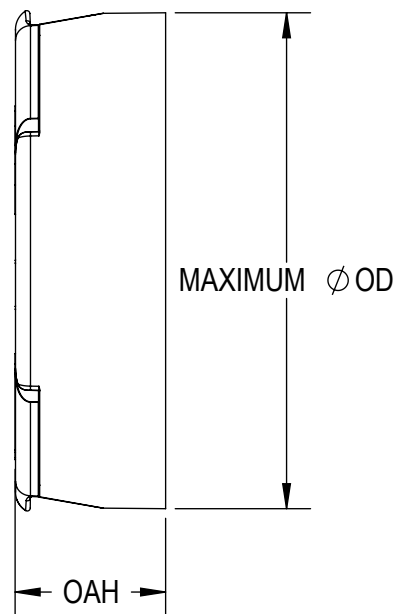
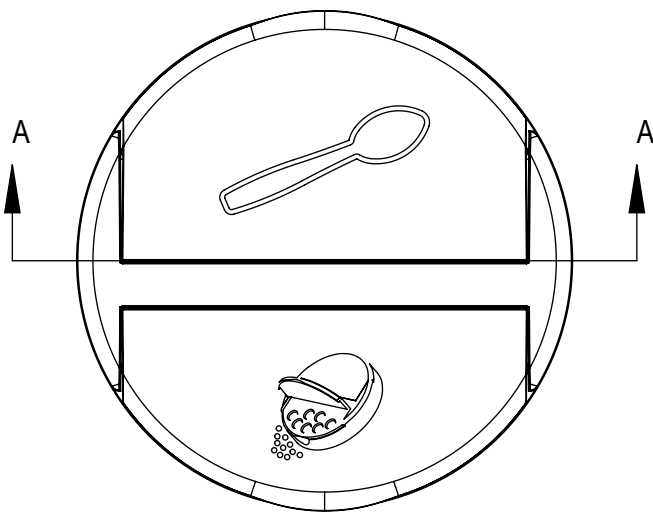

SECTION A-A

THREAD DETAIL INFORMATION
6 THREADS PER INCH, 0.167 PITCH

REFERENCE	TOLERANCE	DIMENSION	UNITS
E	±0.010 [0.25]	2.382 [60.50]	in [mm]
T	±0.010 [0.25]	2.451 [62.26]	in [mm]
H	±0.010 [0.25]	0.622 [15.8]	in [mm]
OAH	±0.015 [0.38]	0.782 [19.86]	in [mm]
OD	±0.015 [0.38]	2.585 [65.66]	in [mm]
PART WEIGHT	± 0.50	10.94	g
OPENING FORCE FULL POUR	± 2.0	5.00	lbf
OPENING FORCE SIFT	± 2.0	4.50	lbf

STATIC TORQUE RECOMMENDATION
25-43 in-lbs
THIS REQUIREMENT MAY VARY DEPENDING
UPON BOTTLE MATERIAL, NECK FINISH, AND
CAPPING EQUIPMENT

DRAWING TYPE : CUSTOMER

REPLACES DRAWINGS:

DIMENSIONS ENCLOSED IN ()
INDICATE REFERENCE
DIMENSIONS AND NO TOLERANCE
LIMITS ARE ESTABLISHED

TOLERANCES UNLESS OTHERWISE SPECIFIED

DIMENSION (inches)	TOLERANCE	DIMENSION (mm)	TOLERANCE
0-0.787	±0.006	0-20	±0.152
0.788-1.181	±0.008	21-30	±0.203
1.182-2.756	±0.012	31-70	±0.305
2.757-3.937	±0.016	71-100	±0.406
3.938-5.096	±0.020	101-150	±0.508
5.097-7.874	±0.024	151-200	±0.610
7.875-9.843	±0.032	201-250	±0.813

ANGULAR TOLERANCE ± 2°

PROPRIETARY AND CONFIDENTIAL

The
CARY COMPANY
Est. 1895

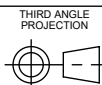

SOLIDWORKS

DISTRIBUTION
CODE

D

DRAWING NAME

63-485 SRN DUAL FLAPPER
FP / 0.125 SIFT

DRAWING NUMBER

CQA - 11278

MATERIAL

POLYPROPYLENE

MODEL NUMBER:

PM 11100 63-485 SRN DF

DRAWN BY:

CAN

9/8/2020

ENG APPR:

CAN

1/24/2022

QA APPR:

DMI

1/24/2022

SCALE

1:1

SHEET SIZE

8.5" X 11"

SHEET

1 of 3

REV/ NP

00.AB

REVISIONS					
DATE	REV.	N/P	DESCRIPTION	ENG	DRW
09/08/2020	00	AA	INITIAL CREATION	CAN	CAN
01/06/2022	00	AB	UPDATED PART WEIGHT TOLERANCE TO REFLECT BEST MANUFACTURING PRACTICES, UPDATED PART WEIGHT TO REFLECT PRODUCTION	CAN	CAN

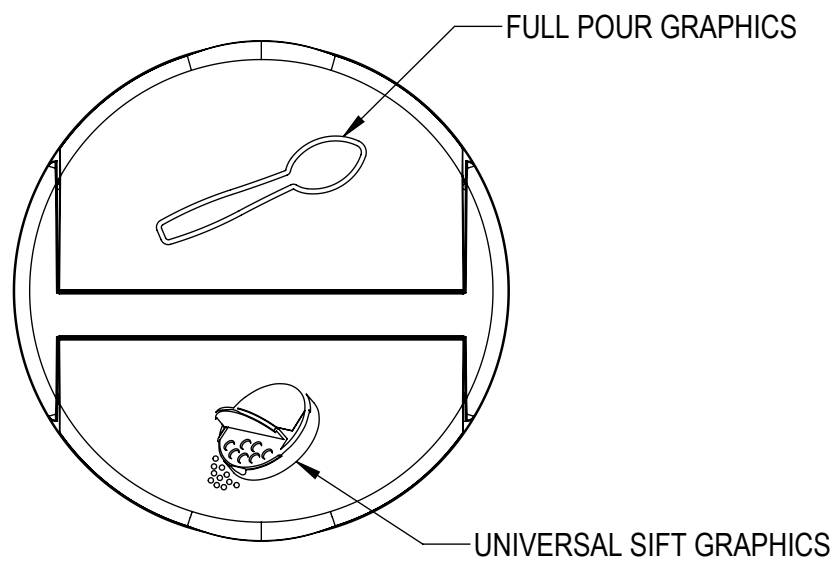
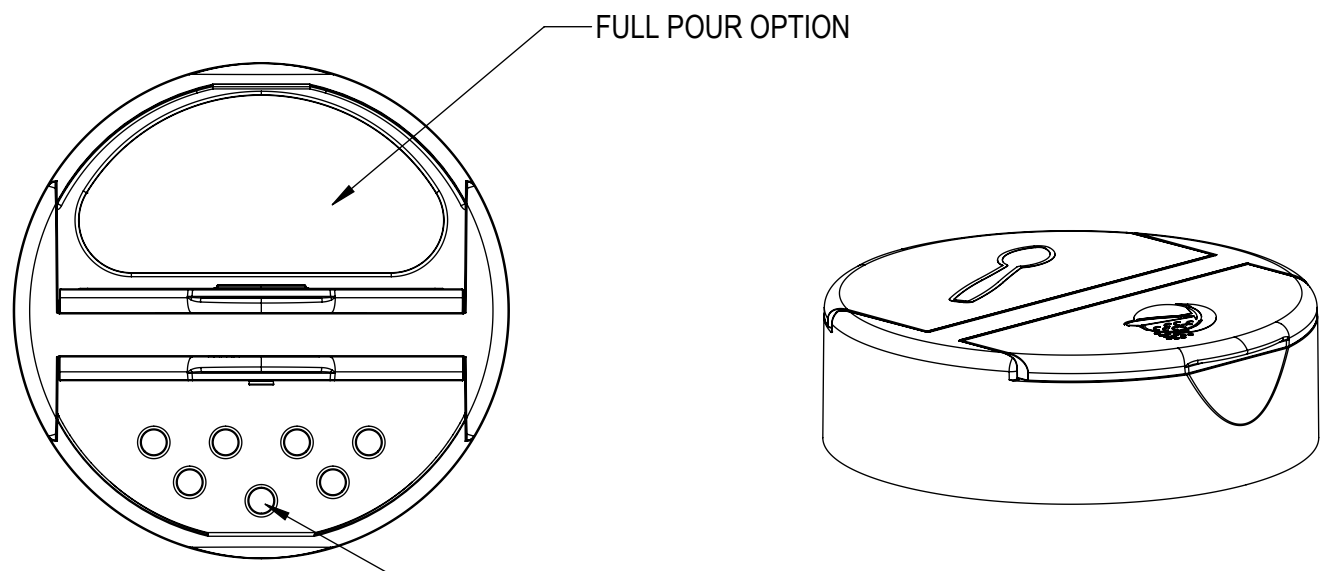

DRAWING TYPE : CUSTOMER			
REPLACES DRAWINGS: 227		DIMENSIONS ENCLOSED IN () INDICATE REFERENCE DIMENSIONS AND NO TOLERANCE LIMITS ARE ESTABLISHED	
TOLERANCES UNLESS OTHERWISE SPECIFIED			
DIMENSION (inches)	TOLERANCE	DIMENSION (mm)	TOLERANCE
0-0.787	±0.006	0-20	±0.152
0.788-1.181	±0.008	21-30	±0.203
1.182-2.756	±0.012	31-70	±0.305
2.757-3.937	±0.016	71-100	±0.406
3.938-5.096	±0.020	101-150	±0.508
5.097-7.874	±0.024	151-200	±0.610
7.875-9.843	±0.032	201-250	±0.813
ANGULAR TOLERANCE ± 2°			
PROPRIETARY AND CONFIDENTIAL			

 THIRD ANGLE PROJECTION	DISTRIBUTION CODE D	DRAWING NAME 63-485 SRN DUAL FLAPPER FP / 0.125 SIFT	
		DRAWING NUMBER CQA - 11278	
DRAWN BY: CAN	9/8/2020	MATERIAL POLYPROPYLENE	
ENG APPR: CAN	1/24/2022	MODEL NUMBER: PM 11100 63-485 SRN DF	
QA APPR: DMI	1/24/2022	SCALE 1:1	SHEET SIZE 8.5 X 11
		SHEET 2 of 3	REV.NP

CRITICAL FOR ORIENTATION
 0.001"=2° IN ROTATION
 S' .190
 [4.82]

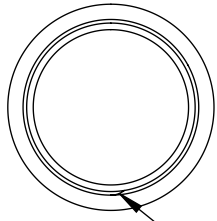

THREAD START

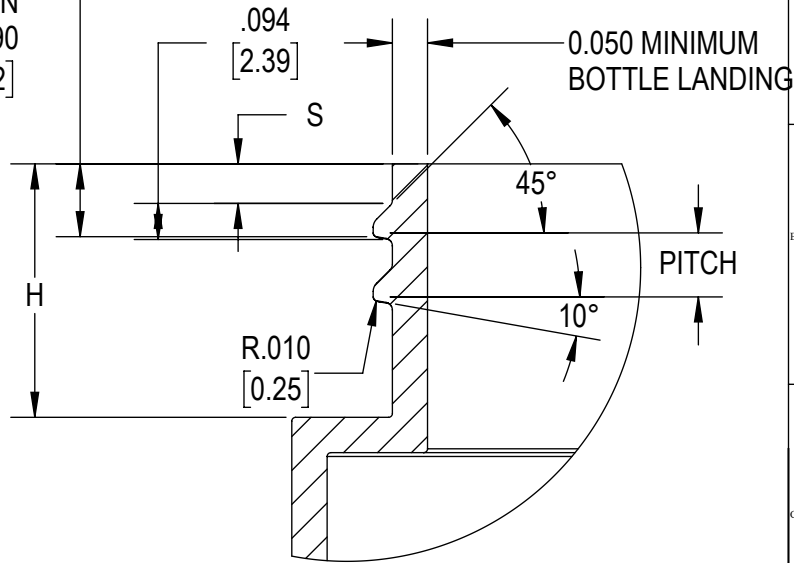

DETAIL THREAD
 SCALE 2 : 1

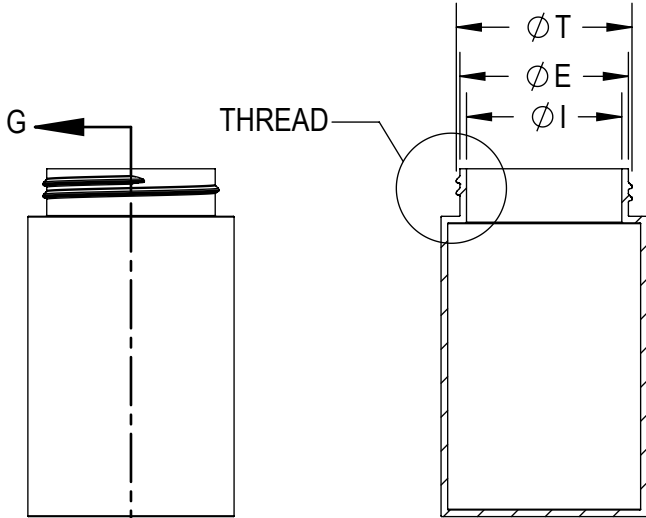

SECTION G-G

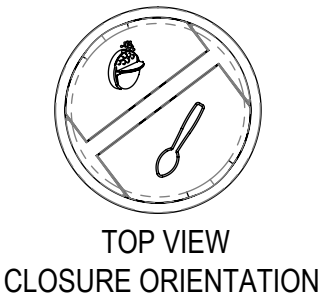

REFERENCE	TOLERANCE	UNITS	DIMENSION
E	±0.015 [038]	in [mm]	2.340 [59.44]
T	±0.015 [0.38]	in [mm]	2.440 [61.98]
I	MINIMUM	in [mm]	1.972 [50.09]
S	±0.007 [0.18]	in [mm]	0.103 [2.62]
H	MINIMUM	in [mm]	0.660 [16.76]
PITCH		in [mm]	0.167
TPI			6

DRAWING TYPE : CUSTOMER			
		DIMENSIONS ENCLOSED IN () INDICATE REFERENCE DIMENSIONS AND NO TOLERANCE LIMITS ARE ESTABLISHED	
TOLERANCES UNLESS OTHERWISE SPECIFIED			
DIMENSION (inches)	TOLERANCE	DIMENSION (mm)	TOLERANCE
0-0.787	±0.006	0-20	±0.152
0.788-1.181	±0.008	21-30	±0.203
1.182-2.756	±0.012	31-70	±0.305
2.757-3.937	±0.016	71-100	±0.406
3.938-5.096	±0.020	101-150	±0.508
5.097-7.874	±0.024	151-200	±0.610
7.875-9.843	±0.032	201-250	±0.813
ANGULAR TOLERANCE ± 2°			
PROPRIETARY AND CONFIDENTIAL			

The **CARY COMPANY**
 Est. 1895

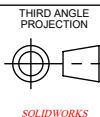

DISTRIBUTION CODE
D

DRAWING NAME
63-485 SRN DUAL FLAPPER RECOMMENDED NECK FINISH
 DRAWING NUMBER
CQA - 11278

DRAWN BY: CAN 9/8/2020
 ENG APPR: CAN 1/24/2022
 QA APPR: DMI 1/24/2022

MATERIAL RECOMMENDED MATERIAL IS PET, HDPE OR LIKE MATERIAL MUST BE VERIFIED FOR FIT AND FUNCTION
 MODEL NUMBER:
 SCALE: 3:8 SHEET SIZE: 8.5X11 SHEET: 3 of 3 REV/N/P: 00.AB