

# IF YOU...

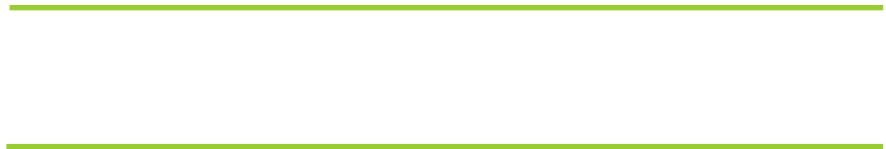

MIX IT. FILL IT. PACK IT. SHIP IT.

# WE HAVE A PRODUCT FOR YOU



Part #	68W26B
Neck Width	24mm
Neck Finish	24-410
Color	Black
Material	PP
Case Pack	4,000 ea.
Pallet Pack	140,000 ea. (35 Cases)



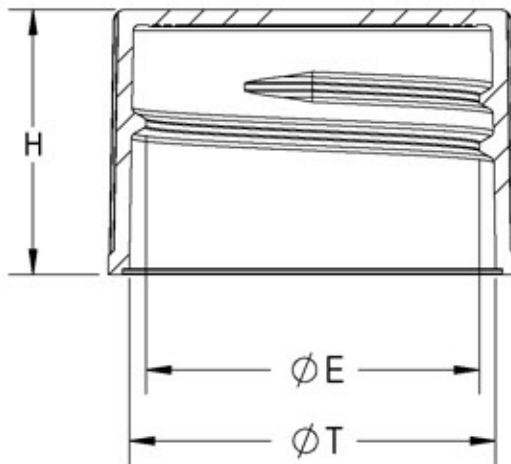
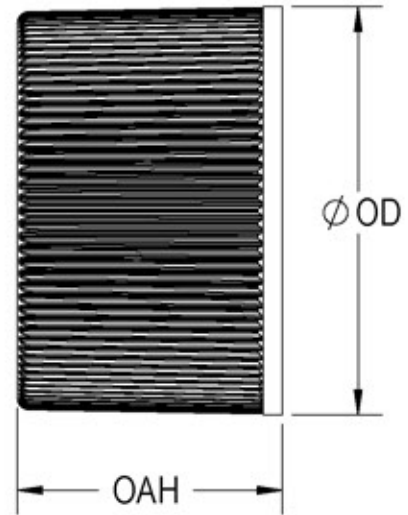
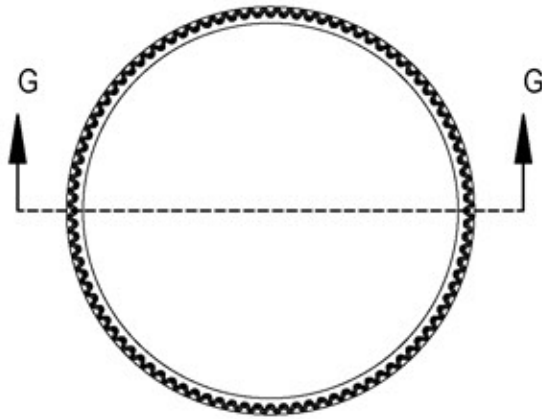

SECTION G-G

THREAD INFORMATION  
8 THREADS PER INCH, .125 PITCH  
1 1/4 TURNS FROM THREAD START

REFERENCE	TOLERANCE	DIMENSION	UNITS
E	$\pm 0.010$ [0.25]	0.868 [22.05]	in [mm]
T	$\pm 0.010$ [0.25]	0.955 [24.26]	in [mm]
H	$\pm 0.010$ [0.25]	0.640 [16.26]	in [mm]
OAH	$\pm 0.010$ [0.25]	0.690 [17.53]	in [mm]
OD	$\pm 0.010$ [0.25]	1.060 [26.92]	in [mm]
PART WEIGHT	$\pm 0.2$	2.0	g

STATIC TORQUE RECOMMENDATION  
**10-18 in-lbs**  
THIS REQUIREMENT MAY VARY DEPENDING  
UPON BOTTLE MATERIAL, NECK FINISH, AND  
CAPPING EQUIPMENT

DRAWING TYPE : CUSTOMER

REPLACES DRAWINGS:  
C-8029

DIMENSIONS ENCLOSED IN ( )  
INDICATE REFERENCE  
DIMENSIONS AND NO TOLERANCE  
LIMITS ARE ESTABLISHED

TOLERANCES UNLESS OTHERWISE SPECIFIED

DIMENSION (inches)	TOLERANCE	DIMENSION (mm)	TOLERANCE
0-0.787	$\pm 0.006$	0-20	$\pm 0.152$
0.788-1.181	$\pm 0.008$	21-30	$\pm 0.203$
1.182-2.756	$\pm 0.012$	31-70	$\pm 0.305$
2.757-3.937	$\pm 0.016$	71-100	$\pm 0.406$
3.938-5.096	$\pm 0.020$	101-150	$\pm 0.508$
5.097-7.874	$\pm 0.024$	151-200	$\pm 0.610$
7.875-9.843	$\pm 0.032$	201-250	$\pm 0.813$

ANGULAR TOLERANCE  $\pm 2^\circ$

PROPRIETARY AND CONFIDENTIAL

The  
**CARY COMPANY**  
Est. 1895

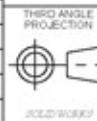

DISTRIBUTION  
CODE  
**D**

DRAWING NAME  
**24-410 CT**  
RL (RIBBED SIDES, MATTE TOP)

DRAWING NUMBER

DRAWN BY: DAS 3/17/2017  
ENG APPR: BDG 4/28/2017  
QA APPR: ACP 05/01/2017

MATERIAL: POLYPROPYLENE  
MODEL NUMBER: PM 10724 24-410 CT

SCALE	SHEET SIZE	SHEET	REVNP
2:1	11in*17in	1 of 3	01.AC

REVISIONS					
DATE	REV.	N/P	DESCRIPTION	ENG	DRW
02/07/14	01	AA	DRAWING CREATED	LGF	LGF
11/04/17	01	AB	UPDATED AS MOLDED (24101) DATA FROM 02/06/14 AND HISTORICAL DATA FROM 24007, ADDED OBOSLETE NOTE, REVISED RECOMMENDED NECK FINISH	LMB	LMB
4/27/16	01	AC	UPDATED DRAWING FORMAT	BDG	DAS

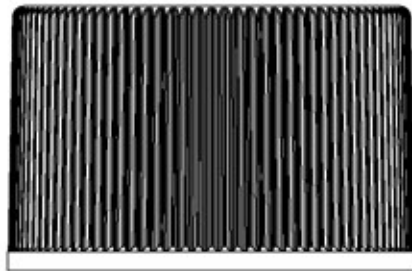
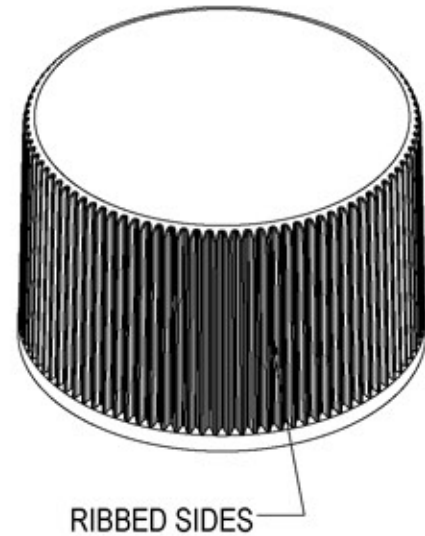
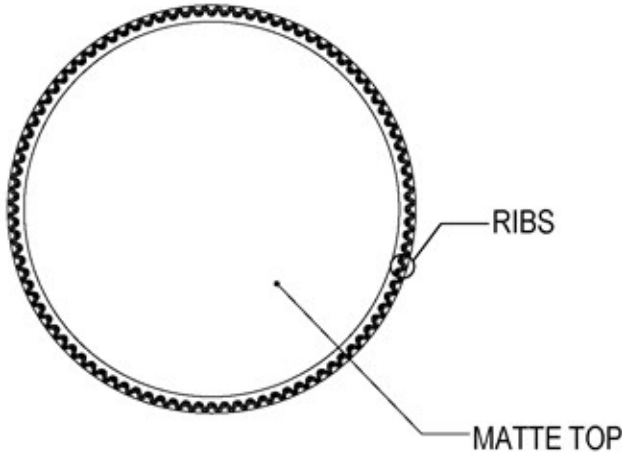

DETAIL RIBS  
SCALE 16 : 1

DRAWING TYPE : CUSTOMER			
REFERENCES: 24007		DIMENSIONS ENCLOSED IN ( ) INDICATE REFERENCE DIMENSIONS AND NO TOLERANCE LIMITS ARE ESTABLISHED	
TOLERANCES UNLESS OTHERWISE SPECIFIED			
DIMENSION (inches)	TOLERANCE	DIMENSION (mm)	TOLERANCE
0-0.787	±0.006	0-20	±0.152
0.788-1.181	±0.008	21-30	±0.203
1.182-2.756	±0.012	31-70	±0.305
2.757-3.937	±0.016	71-100	±0.406
3.938-5.096	±0.020	101-150	±0.508
5.097-7.874	±0.024	151-200	±0.610
7.875-9.843	±0.032	201-250	±0.813
ANGULAR TOLERANCE ± 2°			
PROPRIETARY AND CONFIDENTIAL			

The  
**CARY COMPANY**  
Est. 1895

THIRD ANGLE PROJECTION	DISTRIBUTION CODE <b>D</b>	DRAWING NAME <b>24-410 CT</b> RL (RIBBED SIDES, MATTE TOP)	
DRAWING NUMBER		MATERIAL POLYPROPYLENE	
DRAWN BY: DAS	3/17/2017	MODEL NUMBER: PM 10724 24-410 CT	
ENG APPR. BDG	4/28/2017	SCALE 2:1	SHEET SIZE 8.5 X 11
QA APPR. ACP	05/01/2017	SHEET 2 of 3	REV/NP 01/AC

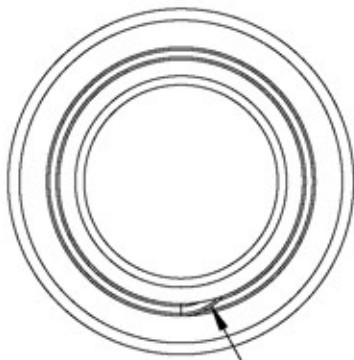

THREAD START

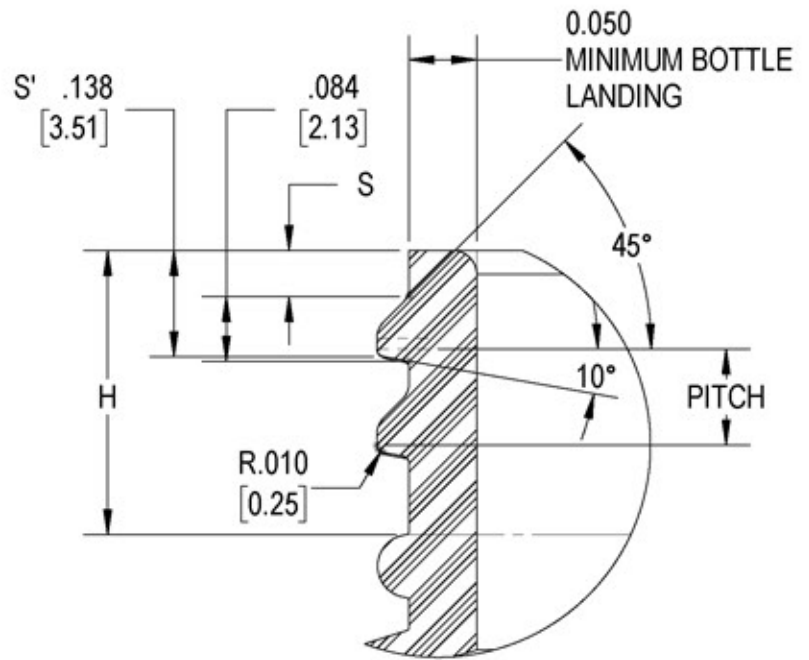

DETAIL THREAD  
SCALE 4 : 1

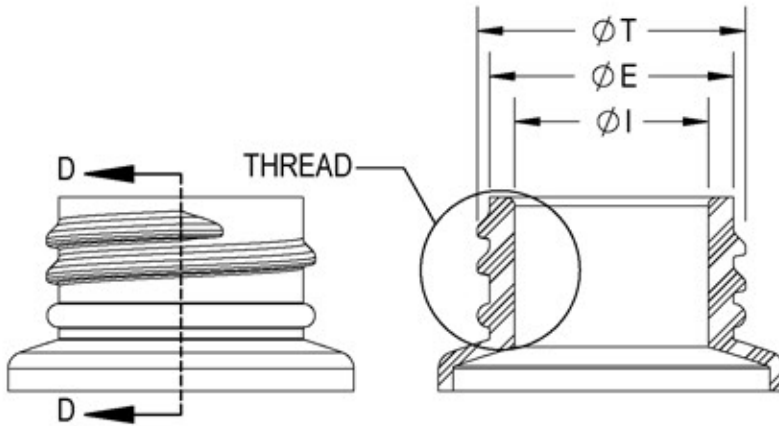

SECTION D-D

REFERENCE	TOLERANCE	UNITS	DIMENSION
E	±0.008 [0.20]	in [mm]	0.848 [21.54]
T	±0.008 [0.20]	in [mm]	0.932 [23.67]
I	MINIMUM	in [mm]	0.661 [16.79]
S	±0.015 [0.38]	in [mm]	0.046 [1.17]
H	±0.015 [0.38]	in [mm]	0.516 [13.11]
PITCH		in [mm]	0.125
TPI			8

NOTE: THE NOMINAL ORIENTATION ILLUSTRATED IS BASED ON NOMINAL DIMENSIONS OF BOTH THE CLOSURE AND THE RECOMMENDED NECK FINISH. FOR EXACT ORIENTATION EACH BOTTLE SHOULD BE EVALUATED ON A CASE BY CASE BASIS.

DRAWING TYPE : CUSTOMER

DIMENSIONS ENCLOSED IN ( ) INDICATE REFERENCE DIMENSIONS AND NO TOLERANCE LIMITS ARE ESTABLISHED

TOLERANCES UNLESS OTHERWISE SPECIFIED

DIMENSION (inches)	TOLERANCE	DIMENSION (mm)	TOLERANCE
0-0.787	±0.006	0-20	±0.152
0.788-1.181	±0.008	21-30	±0.203
1.182-2.756	±0.012	31-70	±0.305
2.757-3.937	±0.016	71-100	±0.406
3.938-5.096	±0.020	101-150	±0.508
5.097-7.874	±0.024	151-200	±0.610
7.875-9.843	±0.032	201-250	±0.813

ANGULAR TOLERANCE ± 2°

PROPRIETARY AND CONFIDENTIAL

The  
**CARY COMPANY**  
Est. 1895

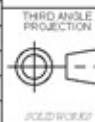

DISTRIBUTION CODE  
**D**

DRAWING NAME  
**24-410 CT  
RECOMMENDED NECK FINISH**  
DRAWING NUMBER

DRAWN BY: DAS 3/17/2017  
ENG APPR: BOG 4/28/2017  
QA APPR: ACP 05/01/2017

MATERIAL  
MODEL NUMBER:  
SCALE: 3:2  
SHEET SIZE: 8.5 X 11  
SHEET: 3 of 3  
REV/NP: 01 AC