

IF YOU...

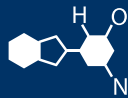

MIX IT. FILL IT. PACK IT. SHIP IT.

WE HAVE A **PRODUCT** FOR YOU

Part #68W28C

Plastic Caps

28mm 28-400 White Child Resistant Cap
(PDT) w/PS22 Liner (Printed)



The
CARYCOMPANY
Est. 1895

1195 W. Fullerton Ave. | Addison, IL 60101 | T: 630.629.6600 | F: 630.629.3690 | TheCaryCompany.com

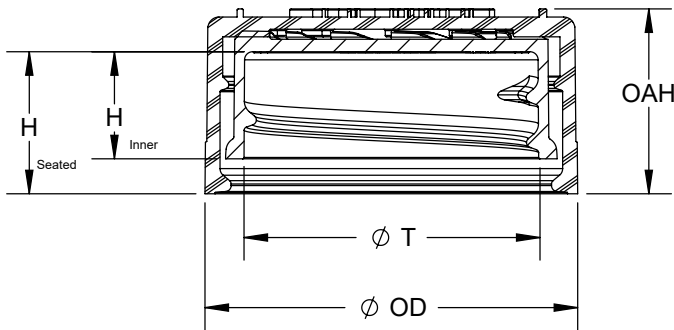
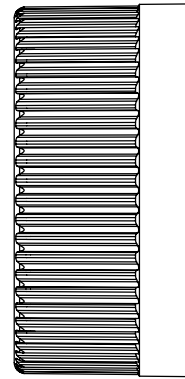
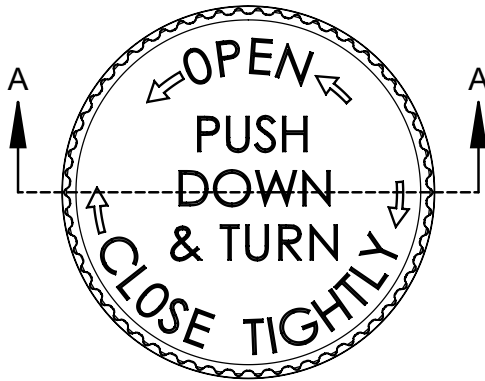

SECTION A-A

6 THREADS PER INCH, .167 PITCH, 380° FULL DEPTH THREAD			
REFERENCE	TOLERANCE	DIMENSION	UNITS
E	±0.012 [0.31]	1.006 [25.60]	in [mm]
T	±0.012 [0.31]	1.100 [27.90]	in [mm]
H [Seated]	REFERENCE	0.514 [13.06]	in [mm]
H [Inner]	±0.012 [0.31]	0.395[10.00]	in [mm]
OD	±0.017[0.43]	1.375 [34.93]	in [mm]
OAH	±0.017[0.43]	0.677 [17.20]	in [mm]
PART WEIGHT	± 0.80	4.90	g

DRAWING TYPE : CUSTOMER

STATIC TORQUE RECOMMENDATION
12-21 in-lbs
THIS REQUIREMENT MAY VARY DEPENDING
UPON BOTTLE MATERIAL, NECK FINISH, AND
CAPPING EQUIPMENT

REPLACES DRAWINGS:
C-8022

DIMENSIONS ENCLOSED IN ()
INDICATE REFERENCE
DIMENSIONS AND NO TOLERANCE
LIMITS ARE ESTABLISHED

TOLERANCES UNLESS OTHERWISE SPECIFIED

DIMENSION (inches)	TOLERANCE	DIMENSION (mm)	TOLERANCE
0-0.787	±0.006	0-20	±0.152
0.788-1.181	±0.008	21-30	±0.203
1.182-2.756	±0.012	31-70	±0.305
2.757-3.937	±0.016	71-100	±0.406
3.938-5.096	±0.020	101-150	±0.508
5.097-7.874	±0.024	151-200	±0.610
7.875-9.843	±0.032	201-250	±0.813

ANGULAR TOLERANCE ± 2°

PROPRIETARY AND CONFIDENTIAL

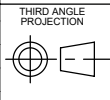

SOLIDWORKS

DISTRIBUTION
CODE

D

DRAWING NAME

28-400 CRC Assm
PDT Emboss

DRAWING NUMBER

CQA - 10212

MATERIAL

POLYPROPYLENE

MODEL NUMBER:

PM 10214 28-400 CRC PDT ASM

SCALE

1.5:1

SHEET SIZE

8.5" X 11"

SHEET

1 of 3

REV.NP

01.AE

DRAWN BY:

BDG

1/20/2016

ENG APPR.

CRS

1/19/2022

QA APPR.

TEM

1/21/2022

THE CLOSURE DIMENSIONS
DEPICTED ARE THOSE WHICH HAVE GENERALLY BEEN
FOUND TO BE FUNCTIONAL BASED ON INDUSTRY
EXPERIENCE BECAUSE OF VARIABILITY IN GLASS AND
PLASTIC CONTAINER FINISHES. EACH CLOSURE/FINISH
SYSTEM SHOULD BE INDIVIDUALLY EVALUATED AND
TESTED TO ENSURE IT MEETS APPLICABLE
PERFORMANCE CRITERIA. SEE QUALITY ASSURANCE
SPECIFICATIONS FOR ADDITIONAL INFORMATION.

DATE	REV	N/P	DESCRIPTION	ENG	DRWN
01/20/2016	01	AA	DRAWING RELEASED	BDG	BDG
09/09/2016	01	AB	CORRECTED H REFERENCE ON PAGE 3	BDG	BDG
07/07/2017	01	AC	CORRECTED RIB COUNT	JDM	JDM
02/20/2019	01	AD	CORRECTED H/H1 REFERENCE ON PAGE 3	BDG	BDG
01/17/2022	01	AE	CORRECTED RECOMMENDED NECK FINISH ERRORS, NO PART CHANGE	BDG	CRS

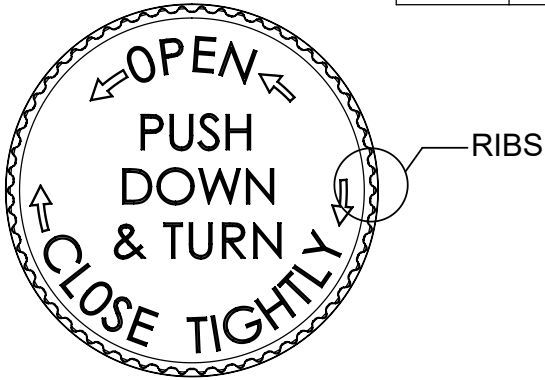

MATTE FINISH TOP AND SIDES

RAISED LOGO

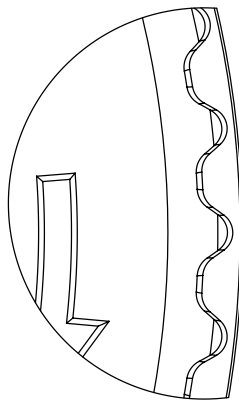

DETAIL RIBS
SCALE 8 : 1

(58) EQUISPACED RIBS



THE CLOSURE DIMENSIONS DEPICTED ARE THOSE WHICH HAVE GENERALLY BEEN FOUND TO BE FUNCTIONAL BASED ON INDUSTRY EXPERIENCE BECAUSE OF VARIABILITY IN GLASS AND PLASTIC CONTAINER FINISHES. EACH CLOSURE/FINISH SYSTEM SHOULD BE INDIVIDUALLY EVALUATED AND TESTED TO ENSURE IT MEETS APPLICABLE PERFORMANCE CRITERIA. SEE QUALITY ASSURANCE SPECIFICATIONS FOR ADDITIONAL INFORMATION.

DRAWING TYPE : CUSTOMER			
REFERENCES:		DIMENSIONS ENCLOSED IN () INDICATE REFERENCE DIMENSIONS AND NO TOLERANCE LIMITS ARE ESTABLISHED	
TOLERANCES UNLESS OTHERWISE SPECIFIED			
DIMENSION (inches)	TOLERANCE	DIMENSION (mm)	TOLERANCE
0-0.787	±0.006	0-20	±0.152
0.788-1.181	±0.008	21-30	±0.203
1.182-2.756	±0.012	31-70	±0.305
2.757-3.937	±0.016	71-100	±0.406
3.938-5.096	±0.020	101-150	±0.508
5.097-7.874	±0.024	151-200	±0.610
7.875-9.843	±0.032	201-250	±0.813
ANGULAR TOLERANCE ± 2°			
PROPRIETARY AND CONFIDENTIAL			

THIRD ANGLE PROJECTION	DISTRIBUTION CODE	DRAWING NAME	
		28-400 CRC Assm PDT Emboss	
SOLIDWORKS	D	DRAWING NUMBER	
		CQA - 10212	
DRAWN BY.	BDG	1/20/2016	MATERIAL
ENG APPR.	CRS	1/19/2022	POLYPROPYLENE
QA APPR.	TEM	1/21/2022	MODEL NUMBER:
			PM 10214 28-400 CRC PDT ASM
			SCALE SHEET SIZE SHEET REV.NP
			1.5:1 8.5" X 11" 2 of 3 01.AE

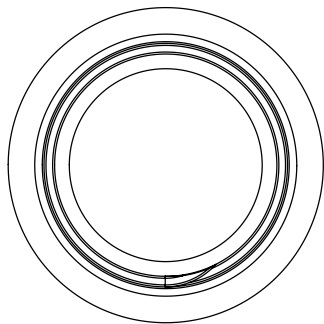

OPTIONAL Construction:
Bead not required for child
resistant closure function

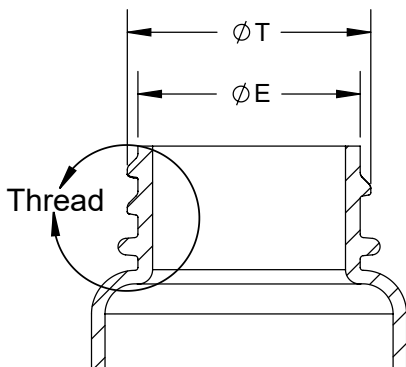
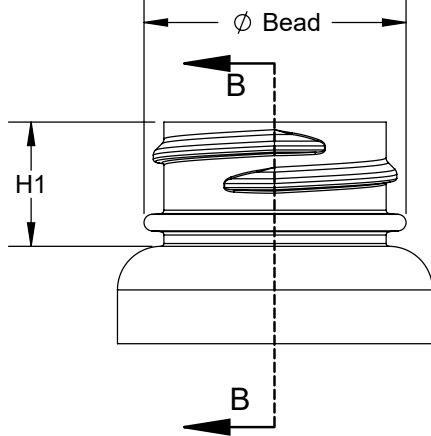

SECTION B-B
SCALE 5 : 4

.050" MINIMUM flat for induction sealing

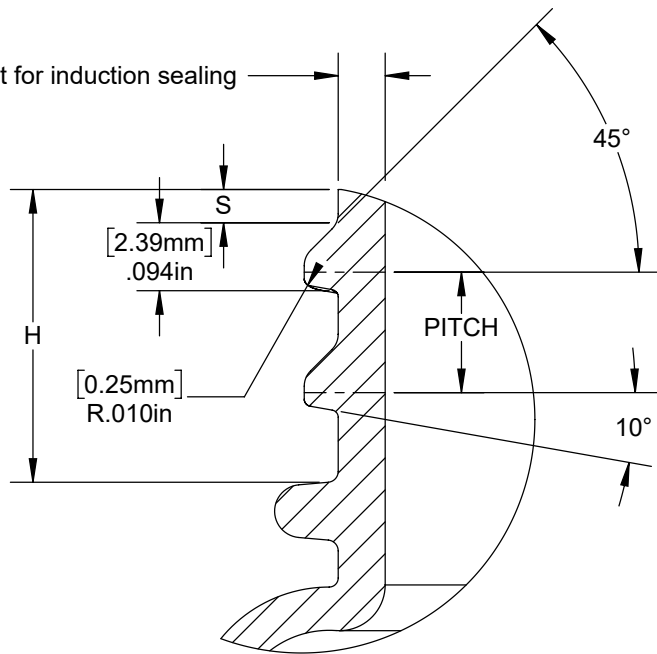

DETAIL Thread
SCALE 4 : 1

REFERENCE	TOLERANCE	UNITS	DIMENSION
E	± 0.010 [0.25]	in [mm]	0.984 [24.99]
T	± 0.010 [0.25]	in [mm]	1.078 [27.38]
S	±0.015 [0.38]	in [mm]	0.046 [1.17]
H	MINIMUM	in [mm]	0.411 [10.44]
H1	MINIMUM	in [mm]	0.550 [13.97]
BEAD	MAXIMUM	in [mm]	1.130 [29.46]
TPI			6
PITCH		in [mm]	0.167 [4.24]

NOTE: THE NOMINAL ORIENTATION ILLUSTRATED IS BASED ON NOMINAL DIMENSIONS OF BOTH THE CLOSURE AND THE RECOMMENDED NECK FINISH. FOR EXACT ORIENTATION EACH BOTTLE SHOULD BE EVALUATED ON A CASE BY CASE BASIS.

DRAWING TYPE : CUSTOMER

DIMENSIONS ENCLOSED IN () INDICATE REFERENCE DIMENSIONS AND NO TOLERANCE LIMITS ARE ESTABLISHED

TOLERANCES UNLESS OTHERWISE SPECIFIED

DIMENSION (inches)	TOLERANCE	DIMENSION (mm)	TOLERANCE
0-0.787	±0.006	0-20	±0.152
0.788-1.181	±0.008	21-30	±0.203
1.182-2.756	±0.012	31-70	±0.305
2.757-3.937	±0.016	71-100	±0.406
3.938-5.096	±0.020	101-150	±0.508
5.097-7.874	±0.024	151-200	±0.610
7.875-9.843	±0.032	201-250	±0.813

ANGULAR TOLERANCE ± 2°

PROPRIETARY AND CONFIDENTIAL

THE CLOSURE DIMENSIONS DEPICTED ARE THOSE WHICH HAVE GENERALLY BEEN FOUND TO BE FUNCTIONAL BASED ON INDUSTRY EXPERIENCE BECAUSE OF VARIABILITY IN GLASS AND PLASTIC CONTAINER FINISHES. EACH CLOSURE/FINISH SYSTEM SHOULD BE INDIVIDUALLY EVALUATED AND TESTED TO ENSURE IT MEETS APPLICABLE PERFORMANCE CRITERIA. SEE QUALITY ASSURANCE SPECIFICATIONS FOR ADDITIONAL INFORMATION.

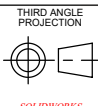

DISTRIBUTION CODE
D

DRAWING NAME
**28-400 CRC Assm
RECOMMENDED NECK FINISH**

DRAWING NUMBER
CQA - 10212

DRAWN BY: BDG 1/20/2016
ENG APPR: CRS 1/19/2022
QA APPR: TEM 1/21/2022

MATERIAL
MODEL NUMBER:
SCALE: 5:4 SHEET SIZE: 8.5" X 11" SHEET: 3 of 3 REV.N/P: 01.AE