

IF YOU...



MIX IT. FILL IT. PACK IT. SHIP IT.

WE HAVE A **PRODUCT** FOR YOU

Part # 68WSHN

1 Gallon Natural HDPE Plastic Slant F-Style
Bottle, 38mm 38-400



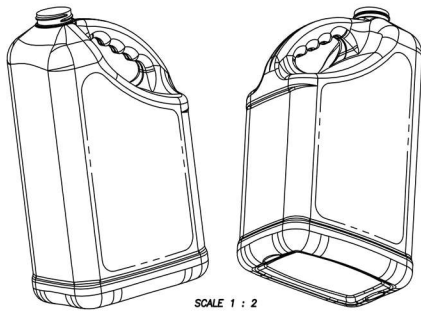

SCALE 1 : 2

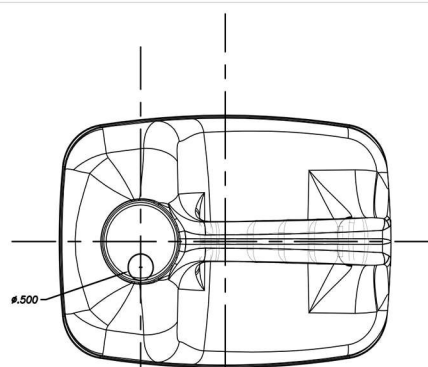

.500

1.682

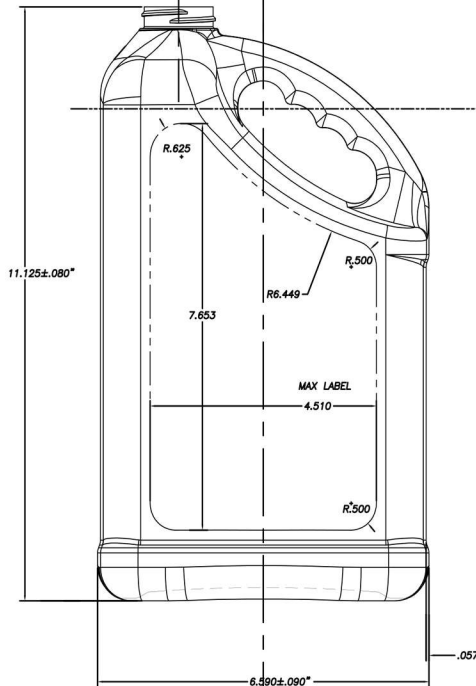
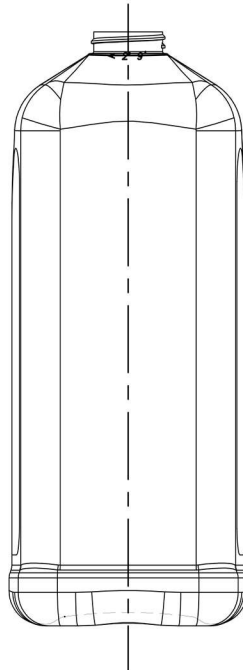

11.125 ± .080"

R.625

R6.449

R.500

7.653

MAX LABEL

4.510

R.500

.057

6.590 ± .090"

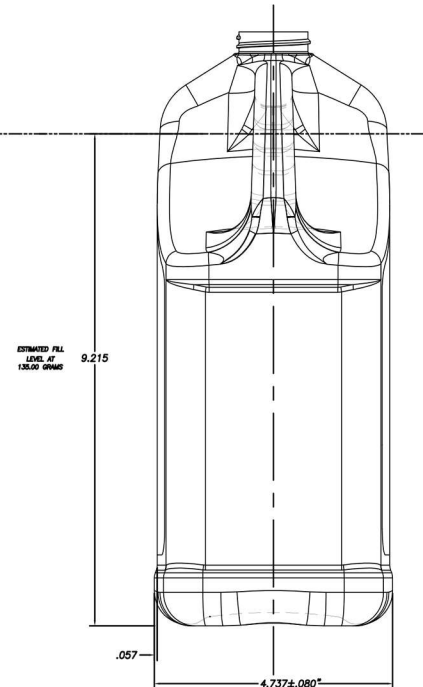

ESTIMATED FILL LEVEL AT 135.00 GRAMS

9.215

.057

4.737 ± .080"

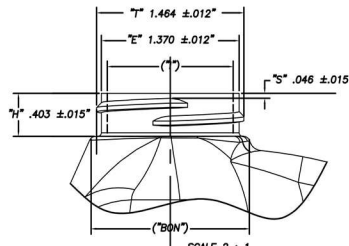

SCALE 2 : 1

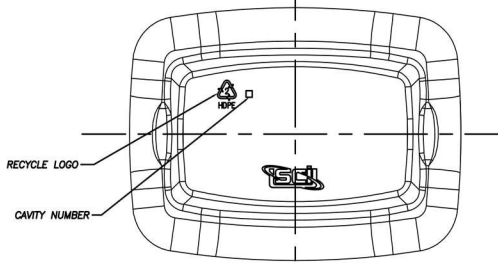

RECYCLE LOGO

CAVITY NUMBER

NECK FINISH: SP400 M38	HELIX			
THREAD ROTATIONS: 1.0	T.P.I.: 6	CUTTER DIA: .500		
	"E"	"S"	"S"	"T"
MAXIMUM	1.476	1.382	.418	.061
MINIMUM	1.452	1.358	.388	.031
MEAN	1.464	1.370	.403	.046
FILL POINT CAPACITY: 128.00 FL.OZ. (3786.12ml)	1.573	X:XXX		
PRODUCT MATERIAL: H.D.P.E.				
BOTTLE BULGE: 2.54 FL.OZ. (75.13ml)				
OVERFLOW CAPACITY INCLUDING BULGE: 135 FL.OZ. (3993.30ml)				
GRAM WEIGHT: 135.00 GRAMS				

1. DIMENSIONS OR NOTES MARKED WITH A DENOTE CRITICAL CHARACTERISTICS TO BE MONITORED DURING PRODUCTION.
2. DIMENSIONS OR NOTES MARKED WITH A DENOTE CHARACTERISTICS TO BE MONITORED DURING PRODUCTION QUALIFICATION ONLY.
3. ALL DIAMETER DIMENSIONS MARKED WITH OR SHALL BE DETERMINED BY AVERAGING THE MEASUREMENTS AT PARTING LINE AND 90 DEGREES FROM PARTING LINE.
4. REFERENCE ONLY DIMENSIONS CONTAINED IN .
5. MINIMUM CONTAINER WALL THICKNESS: .XXX.
6. CONTAINER TIP LEAD REQUIREMENT TO BE XXX LBS. MINIMUM AT 1/4" REFLECTION.

DISCLAIMER
 -BOTTLE VOLUME IS ESTIMATED UNTIL SAMPLES ARE MADE AND INSPECTED.
 -GRAM WEIGHT IS ESTIMATED
 -BULGE IS ESTIMATED
 -OVERFLOW IS ESTIMATED

The
CARY COMPANY
 Est. 1895

PROJECT NUMBER	1595-09-06	BY	DATE	TITLE	1 GALLON SLANT HANDLE
DRAWN BY	EGM	CHECKED BY	EGM	DESCRIPTION	PRODUCT DRAWING
DATE	7/18/2011	DATE	7/18/2011	DWG. NO.	231PD
SIZE	D	SCALE	1:1	SHEET	1 OF 1 REV.