

IF YOU...



MIX IT. FILL IT. PACK IT. SHIP IT.

WE HAVE A **PRODUCT** FOR YOU

Part #68WW33

Plastic Caps

**33mm 33-400 White Ribbed (Smooth Top)
Plastic Cap, Unlined**



The
CARYCOMPANY
Est. 1895

1195 W. Fullerton Ave. | Addison, IL 60101 | T: 630.629.6600 | F: 630.629.3690 | TheCaryCompany.com

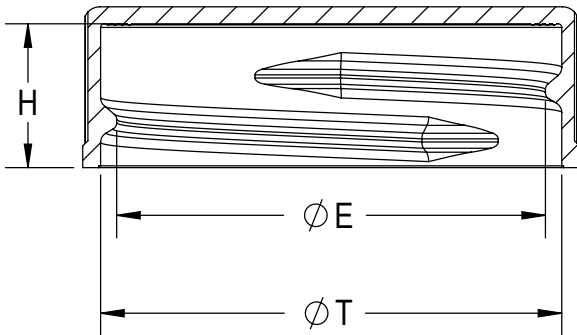
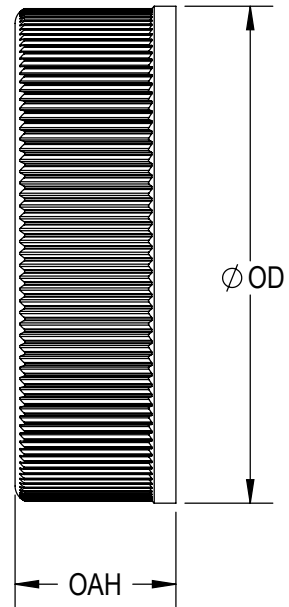
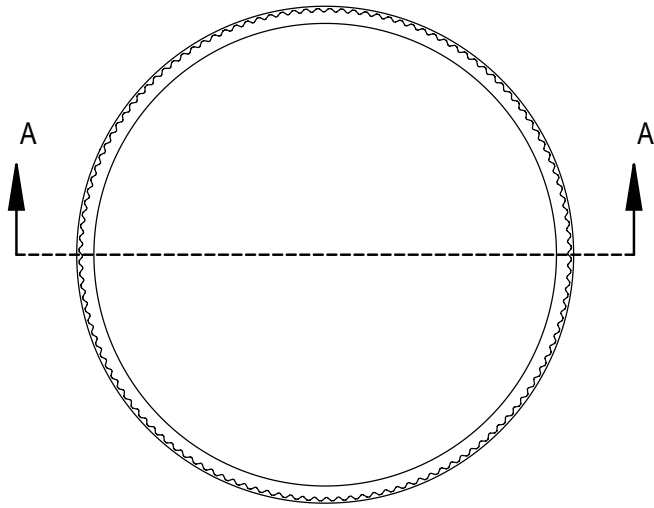

SECTION A-A
SCALE 2 : 1

THREAD DETAIL INFORMATION:
6 THREADS PER INCH, 0.167" PITCH

REFERENCE	TOLERANCE	UNITS	DIMENSION
E	±0.010 [0.25]	in [mm]	1.182 [30.02]
T	±0.010 [0.25]	in [mm]	1.276 [32.41]
H	±0.010 [0.25]	in [mm]	0.398 [10.11]
OAH	±0.010 [0.25]	in [mm]	0.445 [11.3]
OD	±0.010 [0.25]	in [mm]	1.375 [34.93]
PART WEIGHT	±0.30	g	2.10

STATIC TORQUE RECOMMENDATION
15-25 in-lbs
THIS REQUIREMENT MAY VARY DEPENDING
UPON BOTTLE MATERIAL, NECK FINISH, AND
CAPPING EQUIPMENT

THE CLOSURE DIMENSIONS
DEPICTED ARE THOSE WHICH HAVE GENERALLY BEEN
FOUND TO BE FUNCTIONAL BASED ON INDUSTRY
EXPERIENCE BECAUSE OF VARIABILITY IN GLASS AND
PLASTIC CONTAINER FINISHES. EACH CLOSURE/FINISH
SYSTEM SHOULD BE INDIVIDUALLY EVALUATED AND
TESTED TO ENSURE IT MEETS APPLICABLE
PERFORMANCE CRITERIA. SEE QUALITY ASSURANCE
SPECIFICATIONS FOR ADDITIONAL INFORMATION.

DRAWING TYPE : CUSTOMER

REPLACES DRAWINGS:
C-3007

DIMENSIONS ENCLOSED IN ()
INDICATE REFERENCE
DIMENSIONS AND NO TOLERANCE
LIMITS ARE ESTABLISHED

TOLERANCES UNLESS OTHERWISE SPECIFIED

DIMENSION (inches)	TOLERANCE	DIMENSION (mm)	TOLERANCE
0-0.787	±0.006	0-20	±0.152
0.788-1.181	±0.008	21-30	±0.203
1.182-2.756	±0.012	31-70	±0.305
2.757-3.937	±0.016	71-100	±0.406
3.938-5.096	±0.020	101-150	±0.508
5.097-7.874	±0.024	151-200	±0.610
7.875-9.843	±0.032	201-250	±0.813

ANGULAR TOLERANCE ± 2°

PROPRIETARY AND CONFIDENTIAL

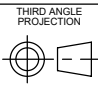

SOLIDWORKS

THIRD ANGLE
PROJECTION

DISTRIBUTION
CODE

D

DRAWING NAME
33-400 CT
RS (RIBBED SIDES, SMOOTH TOP)

DRAWING NUMBER
CQA - 10040

DRAWN BY: DAS 4/6/2017

ENG APPR: CAN 3/20/2020

QA APPR: DMG 03/24/2020

MATERIAL
POLYPROPYLENE

MODEL NUMBER:
PM 10674 33-400 CT

SCALE	SHEET SIZE	SHEET	REV.NP
1:1	8.5in*11in	1 of 3	00.AB

REVISIONS						
DATE	REV	N/P	PRODUCT DRAWING REQUEST	DESCRIPTION	ENG	DRW
04/03/2017	00	AA	17-019	UPDATED DRAWING FORMAT	BDG	DAS
3/19/2020	00	AB		UPDATED RNF H TO 0.408 MINIMUM	CAN	CAN

SMOOTH TOP RIBBED SIDES

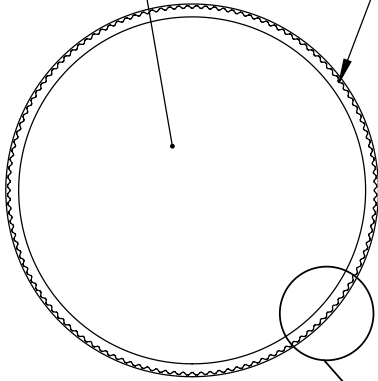

RIBS

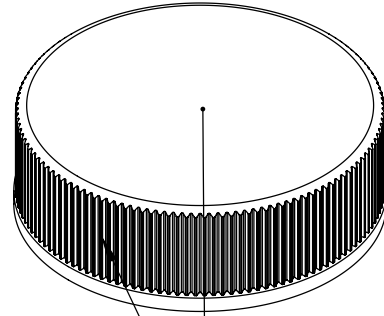

OPTIONAL GATE LOCATION
(SEE TABLE BELOW)

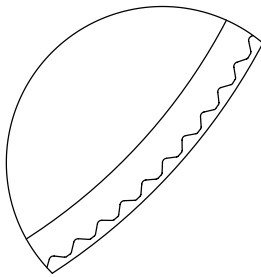

DETAIL RIBS
SCALE 5 : 1

MOLD NUMBER	GATE LOCATION
33001	SIDE
33003	SIDE
33010	SIDE
33014	TOP CENTER

DRAWING TYPE : CUSTOMER

REFERENCES:
33001, 33003, 33010, 33014

DIMENSIONS ENCLOSED IN ()
INDICATE REFERENCE
DIMENSIONS AND NO TOLERANCE
LIMITS ARE ESTABLISHED

TOLERANCES UNLESS OTHERWISE SPECIFIED

DIMENSION (inches)	TOLERANCE	DIMENSION (mm)	TOLERANCE
0-0.787	±0.006	0-20	±0.152
0.788-1.181	±0.008	21-30	±0.203
1.182-2.756	±0.012	31-70	±0.305
2.757-3.937	±0.016	71-100	±0.406
3.938-5.096	±0.020	101-150	±0.508
5.097-7.874	±0.024	151-200	±0.610
7.875-9.843	±0.032	201-250	±0.813

ANGULAR TOLERANCE ± 2°

PROPRIETARY AND CONFIDENTIAL

THE CLOSURE DIMENSIONS
DEPICTED ARE THOSE WHICH HAVE GENERALLY BEEN
FOUND TO BE FUNCTIONAL BASED ON INDUSTRY
EXPERIENCE BECAUSE OF VARIABILITY IN GLASS AND
PLASTIC CONTAINER FINISHES. EACH CLOSURE/FINISH
SYSTEM SHOULD BE INDIVIDUALLY EVALUATED AND
TESTED TO ENSURE IT MEETS APPLICABLE
PERFORMANCE CRITERIA. SEE QUALITY ASSURANCE
SPECIFICATIONS FOR ADDITIONAL INFORMATION.

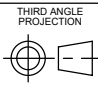

SOLIDWORKS

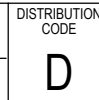

DISTRIBUTION
CODE

DRAWING NAME
33-400 CT
RS (RIBBED SIDES, SMOOTH TOP)

DRAWING NUMBER
CQA - 10040

DRAWN BY. DAS 4/6/2017

MATERIAL
POLYPROPYLENE

ENG APPR. CAN 3/20/2020

MODEL NUMBER:
PM 10674 33-400 CT

QA APPR. DMG 03/24/2020

SCALE	SHEET SIZE	SHEET	REV.NP
3:2	8.5 X 11	2 of 3	00.AB

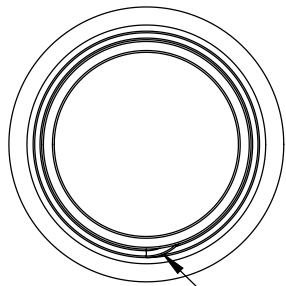

THREAD START

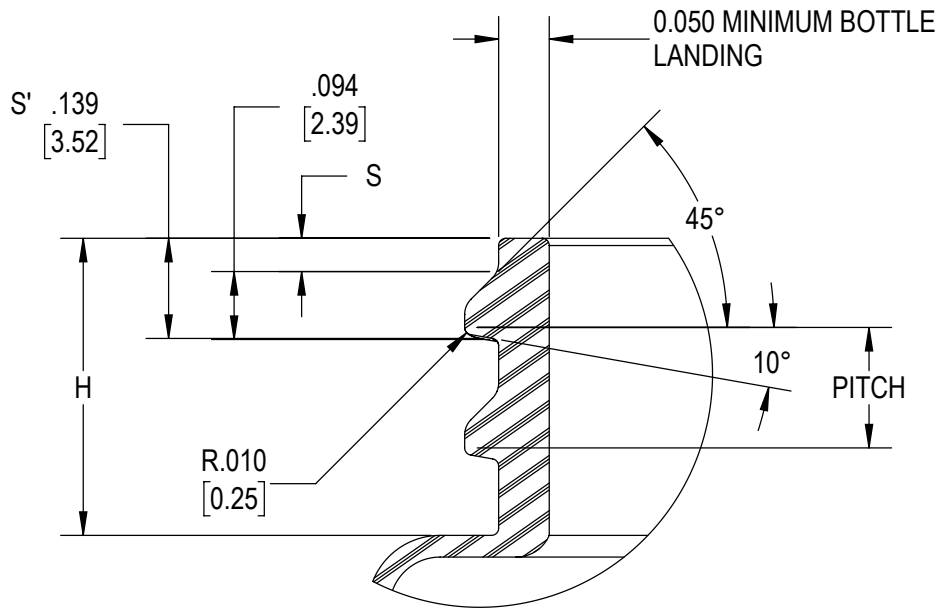

DETAIL THREAD
SCALE 4 : 1

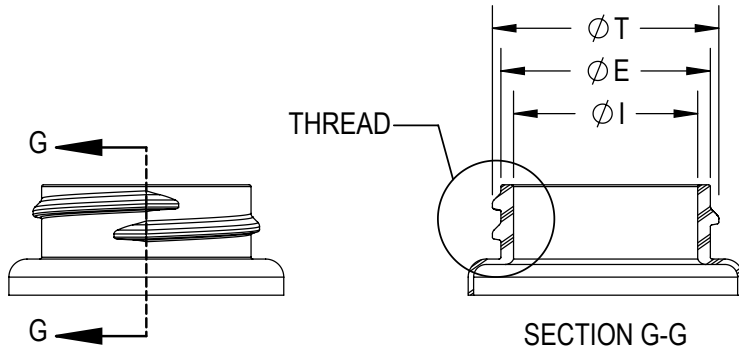

SECTION G-G

REFERENCE	TOLERANCE	UNITS	DIMENSION
E	±0.012 [0.30]	in [mm]	1.159 [29.44]
T	±0.012 [0.30]	in [mm]	1.253 [31.83]
I	MINIMUM	in [mm]	0.791 [20.09]
S	±0.015 [0.38]	in [mm]	0.046 [1.17]
H	MINIMUM	in [mm]	0.408 [10.36]
PITCH		in [mm]	0.167
TPI			6

NOTE: THE NOMINAL ORIENTATION ILLUSTRATED IS BASED ON NOMINAL DIMENSIONS OF BOTH THE CLOSURE AND THE RECOMMENDED NECK FINISH. FOR EXACT ORIENTATION EACH BOTTLE SHOULD BE EVALUATED ON A CASE BY CASE BASIS.

DRAWING TYPE : CUSTOMER

DIMENSIONS ENCLOSED IN () INDICATE REFERENCE DIMENSIONS AND NO TOLERANCE LIMITS ARE ESTABLISHED

TOLERANCES UNLESS OTHERWISE SPECIFIED

DIMENSION (inches)	TOLERANCE	DIMENSION (mm)	TOLERANCE
0-0.787	±0.006	0-20	±0.152
0.788-1.181	±0.008	21-30	±0.203
1.182-2.756	±0.012	31-70	±0.305
2.757-3.937	±0.016	71-100	±0.406
3.938-5.096	±0.020	101-150	±0.508
5.097-7.874	±0.024	151-200	±0.610
7.875-9.843	±0.032	201-250	±0.813

ANGULAR TOLERANCE ± 2°

PROPRIETARY AND CONFIDENTIAL

THIRD ANGLE PROJECTION



SOLIDWORKS

DISTRIBUTION CODE

D

DRAWING NAME

33-400 CT
RECOMMENDED NECK FINISH

DRAWING NUMBER

CQA - 10040

MATERIAL

DRAWN BY: DAS 4/6/2017

ENG APPR: CAN 3/20/2020

QA APPR: DMG 03/24/2020

MODEL NUMBER:

SCALE	SHEET SIZE	SHEET	REV.N/P
1:1	8.5 X 11	3 of 3	00.AB

THE CLOSURE DIMENSIONS DEPICTED ARE THOSE WHICH HAVE GENERALLY BEEN FOUND TO BE FUNCTIONAL BASED ON INDUSTRY EXPERIENCE BECAUSE OF VARIABILITY IN GLASS AND PLASTIC CONTAINER FINISHES. EACH CLOSURE/FINISH SYSTEM SHOULD BE INDIVIDUALLY EVALUATED AND TESTED TO ENSURE IT MEETS APPLICABLE PERFORMANCE CRITERIA. SEE QUALITY ASSURANCE SPECIFICATIONS FOR ADDITIONAL INFORMATION.